

IBIS Login Issue – Setting Change for Microsoft Edge Browsers

If you are receiving an error when logging in to IBIS, please follow the instructions below to make a small settings change to your Microsoft Edge browser. **You do not need to make this change if you are not experiencing an error when trying to login.**

Please make sure you are using the **Microsoft Edge browser** (not Chrome).

1. Open the Microsoft Edge browser. Click the '3-dots' settings icon on the top right.

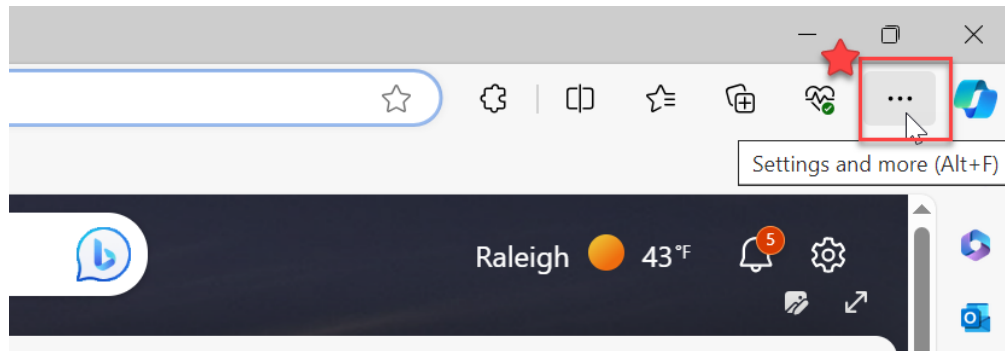

2. Scroll down and select 'Settings'

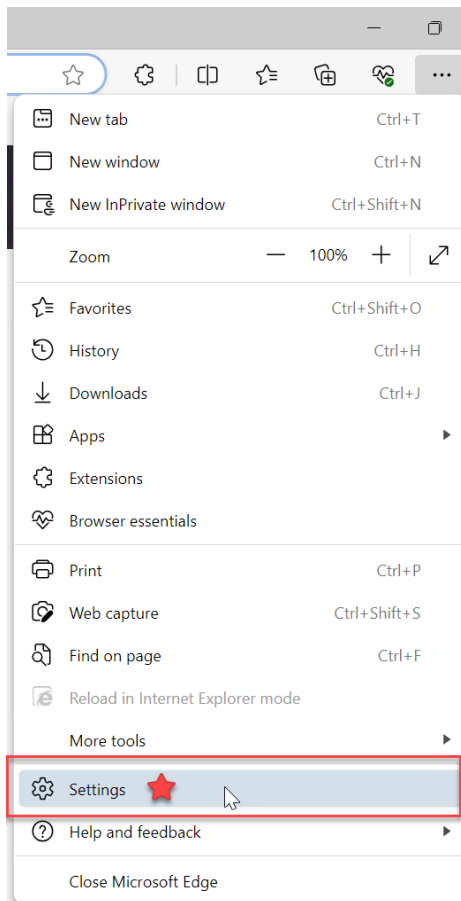

3. Select **Cookies and site permissions** on the left navigation. In the middle section of the page, scroll down and select **Insecure content**.

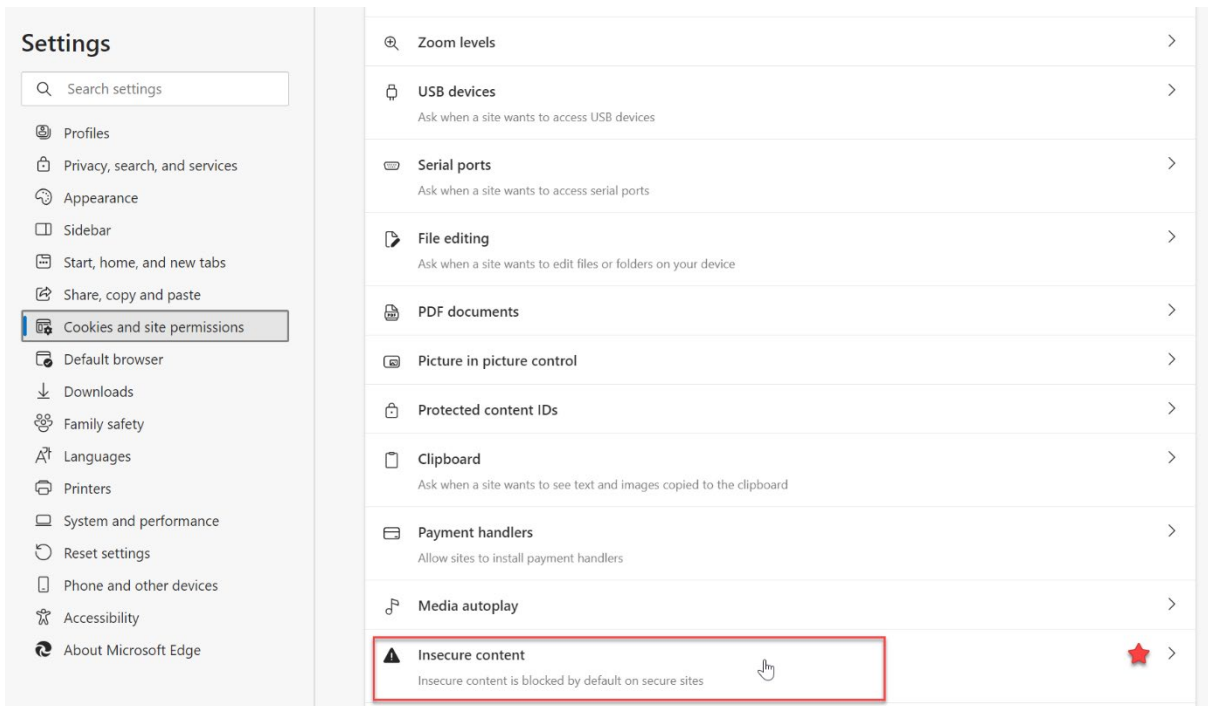

4. In the **Allow** section, click the **Add** button.

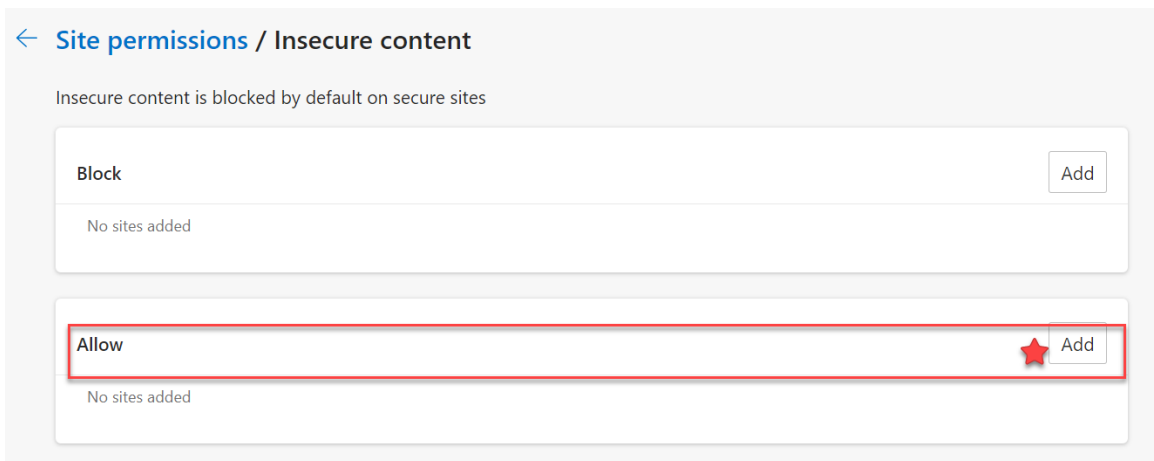

5. When the **Add a site** pop-up window appears, copy and paste this link into the box: <http://ibis.nc.gov> Then click the **ADD** button.

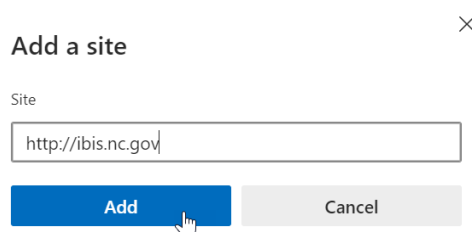

6. You will now see that the IBIS URL has been added in the Allow section

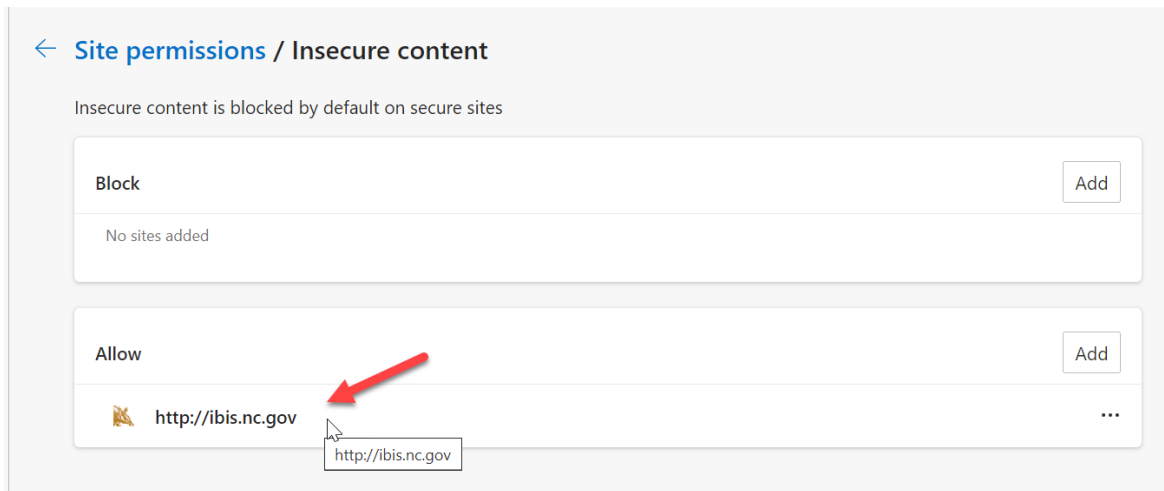

7. Next, on the left navigation bar under Settings, click **Privacy, search, and services** to carry out the steps to clear your browser cache.

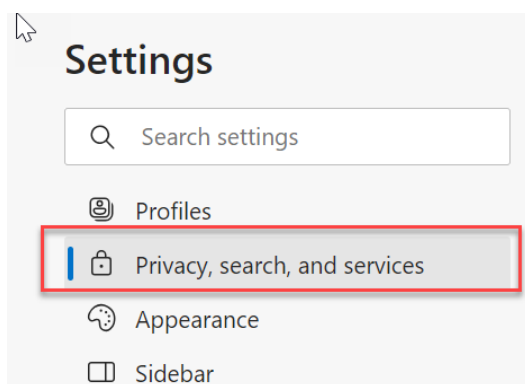

8. Scroll down to the **Clear browsing data** section and click the **Choose what to clear button**.

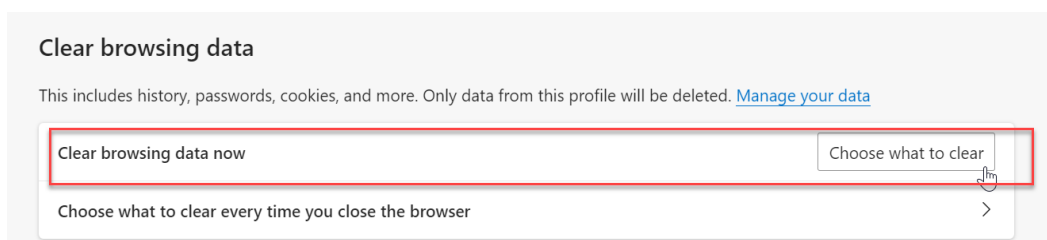

9. On the **Clear browsing data** window, set the **Time Range** to All Time. Set the four checkboxes shown below to CHECKED. Then click the **Clear Now** button.

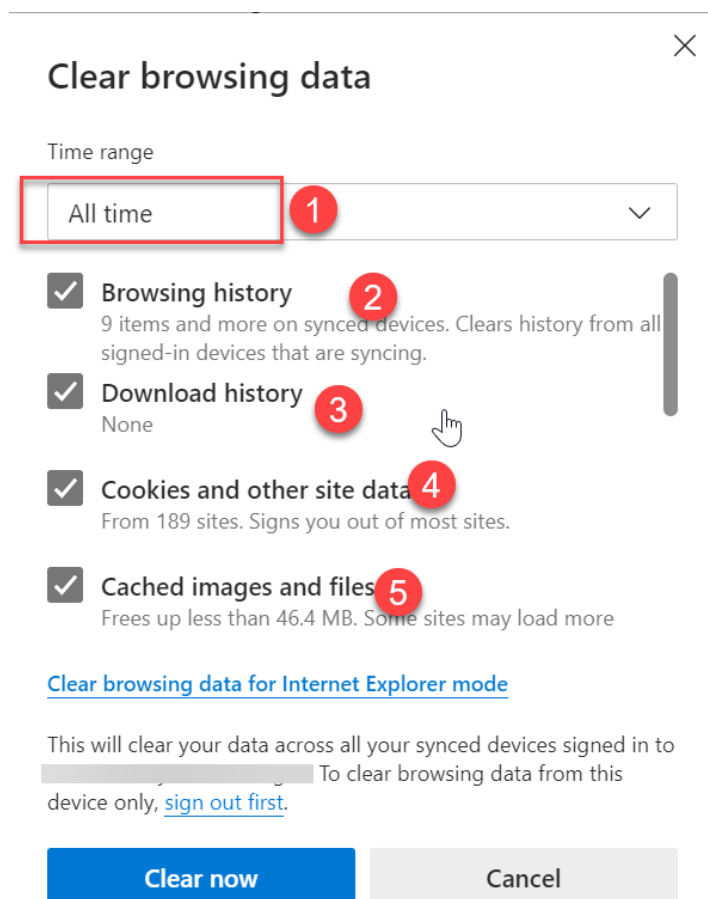

10. **Close the Microsoft Edge browser entirely.** All tabs, full browser shutdown.
11. Reopen the Microsoft Edge browser.
12. From here, please login to IBIS using your normal bookmark, or by typing <http://ibis.nc.gov> in the browser address bar.
13. IBIS should now allow you to login normally.

The IBIS team will continue to investigate this issue. We hope to find a way to update IBIS so that this setting is not needed in the future.

If you continue to experience issues, please log an IBIS Help Desk ticket here: <https://bit.ly/IBISHelp>